

LONGITUDINAL SECTION

NOTE: IF CELLAR IS BANKED OVER WITH EARTH, RETAINING WALLS SHOULD BE BUILT TO PROTECT STEPS AND EMERGENCY WINDOW AT REAR.

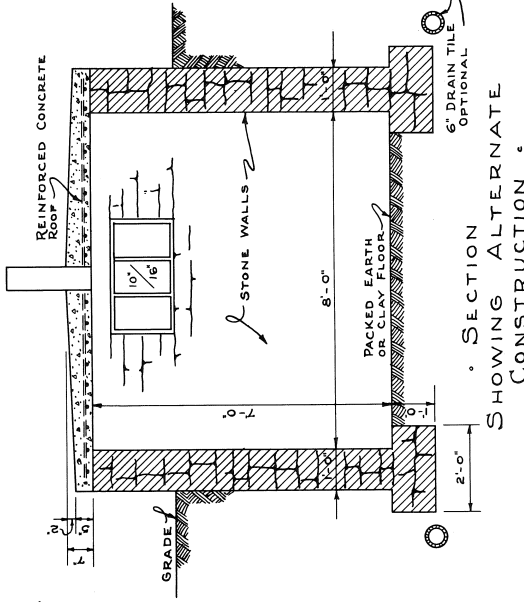

SECTION SHOWING ALTERNATE CONSTRUCTION

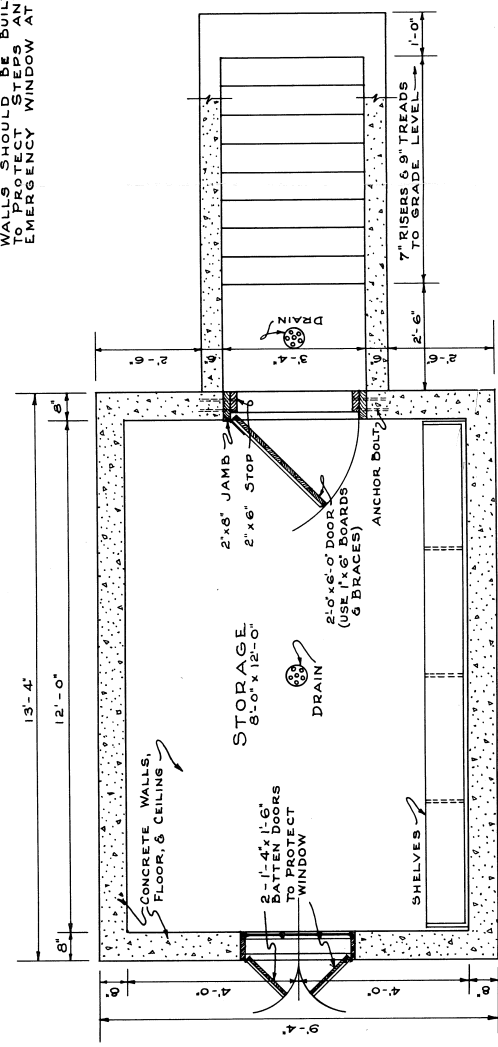

PLAN

STORM CELLAR
 EXTENSION SERVICE
 UNIVERSITY OF ARKANSAS
 COLLEGE OF AGRICULTURE
 AND
 US DEPT OF AGRICULTURE COOPERATING
 DEPT OF AGRICULTURAL ENGINEERING
 SHEET 1 OF 1 PLAN NO. 60192

Disclaimer

This site makes available conceptual plans that can be helpful in developing building layouts and selecting equipment for various agricultural applications. These plans may be outdated and do not necessarily represent the most current technology, construction codes, or agricultural practices. They are not construction plans and do not replace the need for competent design assistance in developing safe, legal and well-functioning agricultural building system. The University of Arkansas Cooperative Extension Service, the United States Department of Agriculture and none of the cooperating land-grant universities warranty these plans.